



werma

WERMA AB

About Werma

Head office in Sunne, Värmland, Sweden.

Werma was founded in 2006

Home market is Sweden, Norway, the Baltics and Germany

Representatives in Denmark, Finland and France

Market and machine base

In Sweden and Norway we have about 70 machines and in rest of Europe there are about 500 machines that we are in contact with.

We consider us to be market leaders regarding hose maintenance

Organisation

Marcus Bergsjö, CEO
Henric Persson, head of sales
Magnus Hedlund, head of technology
Katarina Gåsste, back-office
Mats Bergsjö, CFO
Dennis Leifheit, manager Germany

Service and support: 4 people

Storage and spare parts

In Sunne we have our central storage and all spare parts needed to maintain the machines on the market. We can send on the same day.

Quality and environment

Hose maintenance machines are built according to
ISO-9000 certified process
Machines are CE-marked
Installations and training according to internal quality control by Werma

Werma is ongoing working along UN environmental targets



WERMA WAY

Hose maintenance

Werma has a fully developed program of innovative and efficient products that will protect and support your staff in the work with dirty fire hoses.

Training facilities & Mock-ups

With a unique software and high-end technical solutions training facilities and mock-ups from Werma gives the most realistic and progressive training on the market.

Crash Recovery System

A fast search on the license plate number gives immediate knowledge about the vehicle you have in front of you and supports your decision making.

Drying system

Drying systems supplied by Werma is constructed on air flow and low heat. We have a full range of products, from panels to cabinets.

Fire hoses and couplings

Fire hoses from Werma comes in three different qualities. Premium is Everest, standard is Fuji and rubber hose is called Fryken. All hoses are DIN-certified.

Storage

Our lockers are robust, good looking and self ventilated. An elegant additive is the foldable chair.

Developing projects

Werma is ongoing working together with customers and suppliers to develop new products that will support our customers on daily basis.



WERMA WAY

Werma Concept



01

Our passion is everyday safety and working environment for rescue personal. ersonal.

02

The Werma Way means that every new product or opportunity we see we can implement in our sales must fit in and be supported over time.

03

Around every product category a Werma Concept is built, to support the thought of Werma Way.

04

We create own solutions and products, several are patented, to offer most efficient working environment.

05

Our target is that every hose maintenance room should be optimized to offer best possible working environment.

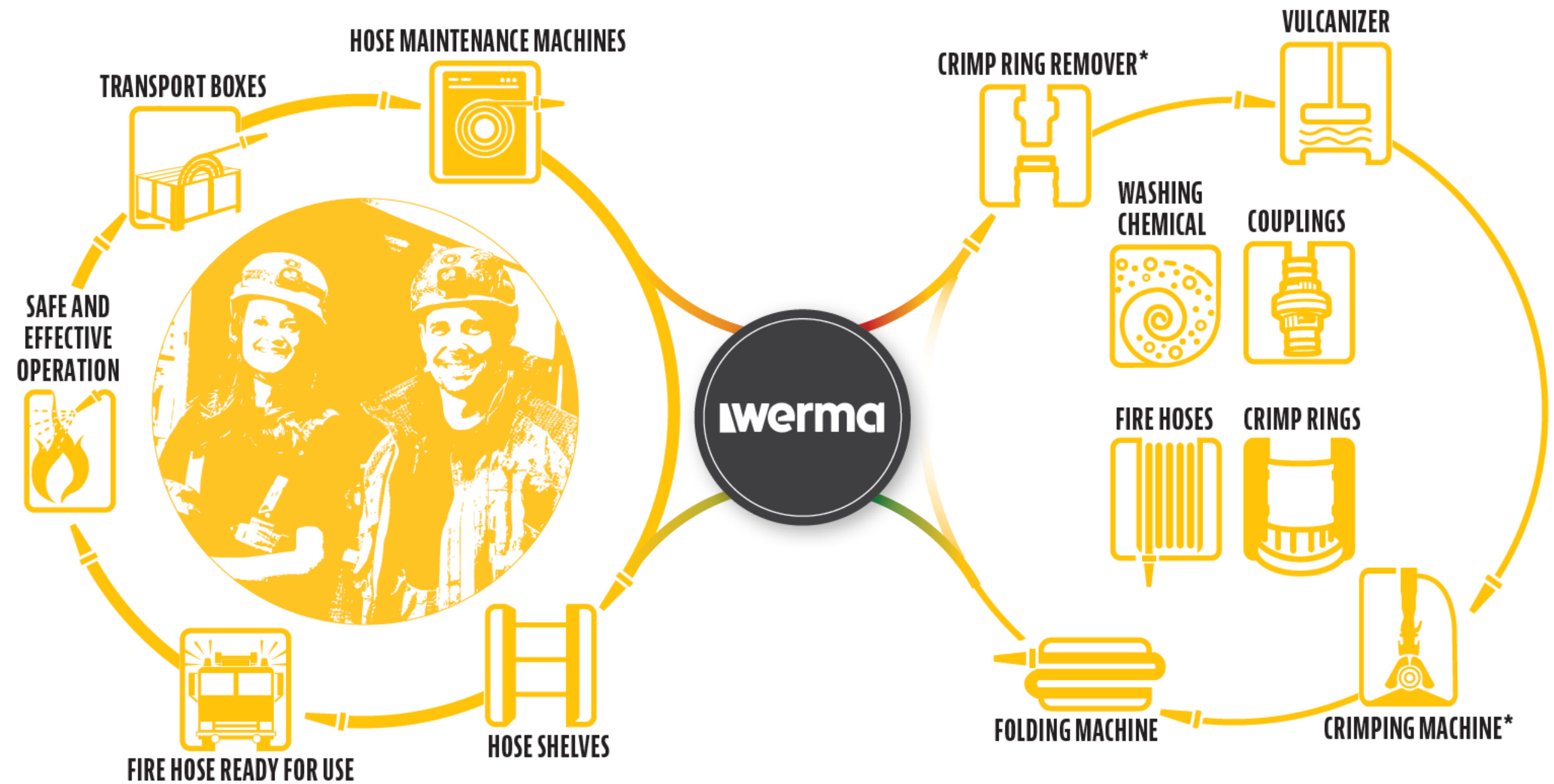

*Patent by WERMA: CM3000 - Crimping machine and CR1800 - Crimp ring remover

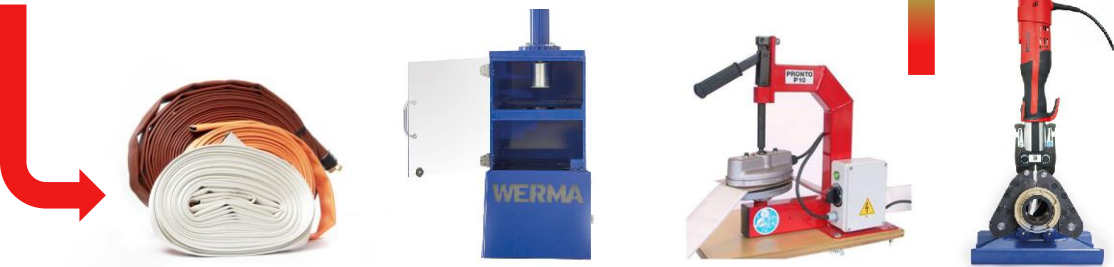
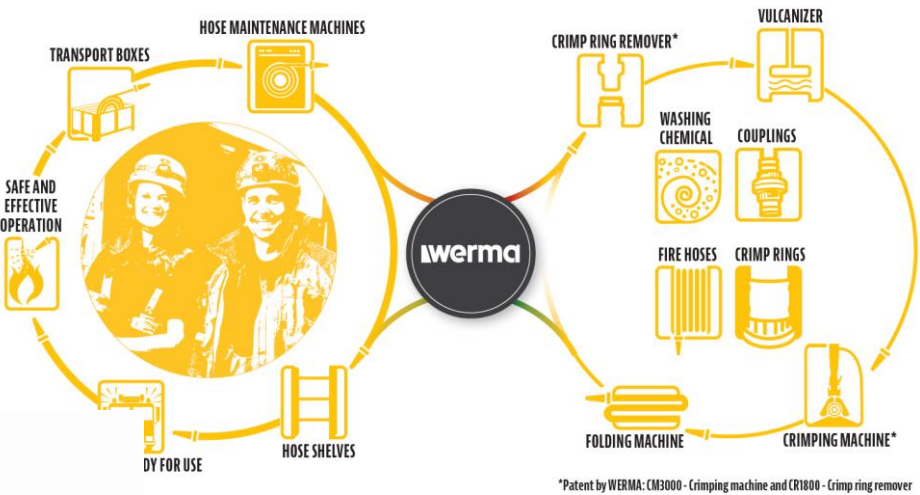





Werma erbjuder olika modeller av slangvårdsmaskiner. Det som förenar maskinerna är att de tvättar, provtrycker, torkar och rullar upp slangen i en automatisk cykel.

HM200

- Stor och tydlig manöverdisplay,
- Tvätt sker med borst och högtrycksmunstycken
- Klarar 19 mm – 110 mm slang (110 mm är tillval)
- Provtrycker variabelt upp till 16 bar
- Finner multipla hål under samma provtryckning
- Full återvinning av provtryckningsvattnet
- Enkel eller dubbelrullar slangen
- Uppkoppling till internet för uppdateringar och support

Teknisk data

- Elförbrukning, ca 4 kw/h
- Vattenförbrukning, ca 22 L/min
- Luftflöde utsug, ca 440 m³/h
- Luftanslutning, 8 bar och 200 L/min
- Vattenanslutning och matning i dimension ¾" med minimum 3 bars konstant vattentryck och ett min-flöde på 22 L/min
- Vattenförsörjningen skall vara kall, detta pga vattnets densitet
- Elanslutning 380/400 V, 32 A med trög europahandske
- Internet, cat 5/6
- Avlopp, min DN50







! +46 54 51 02 00
info@werma.se
www.werma.se

werma

VARNING KLÄMRISK!
Stoppa ej in handen under drift!

werma





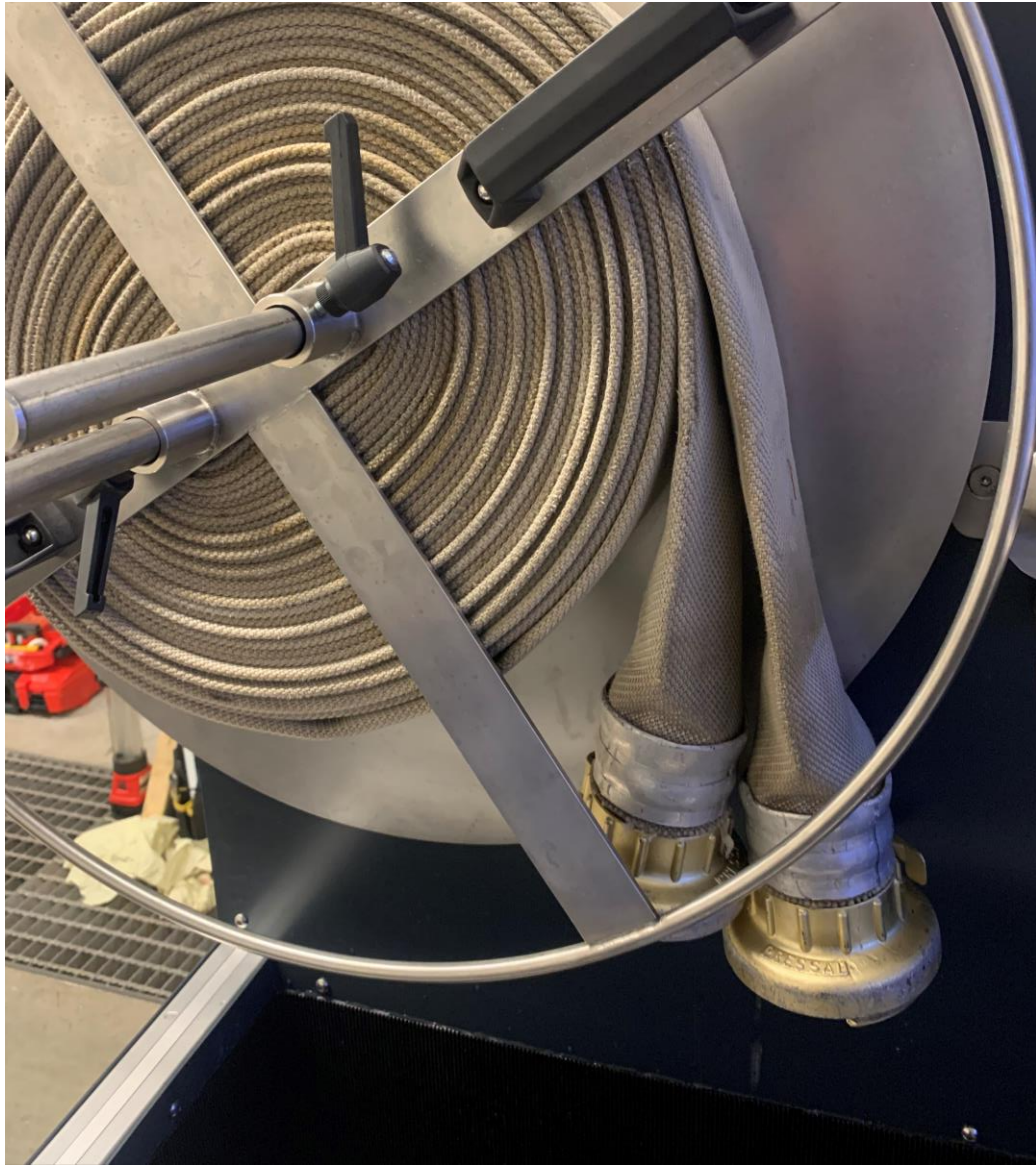



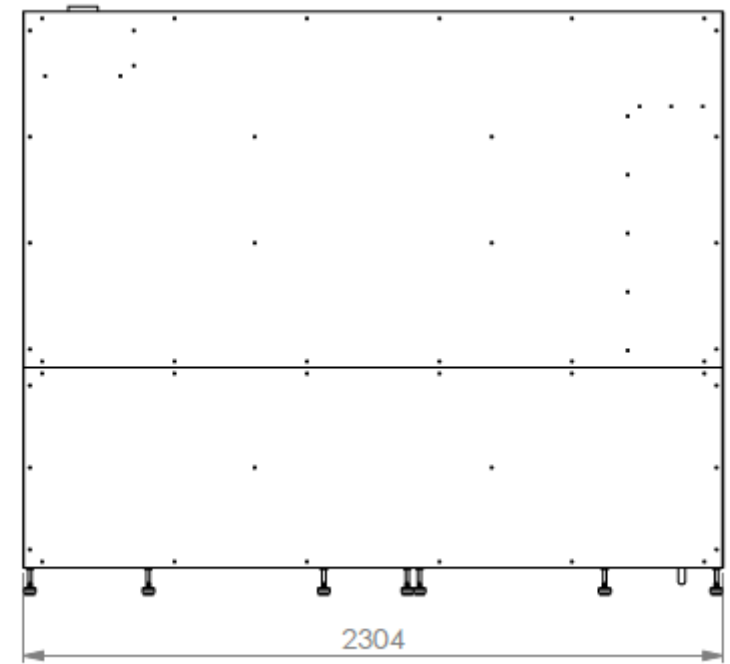
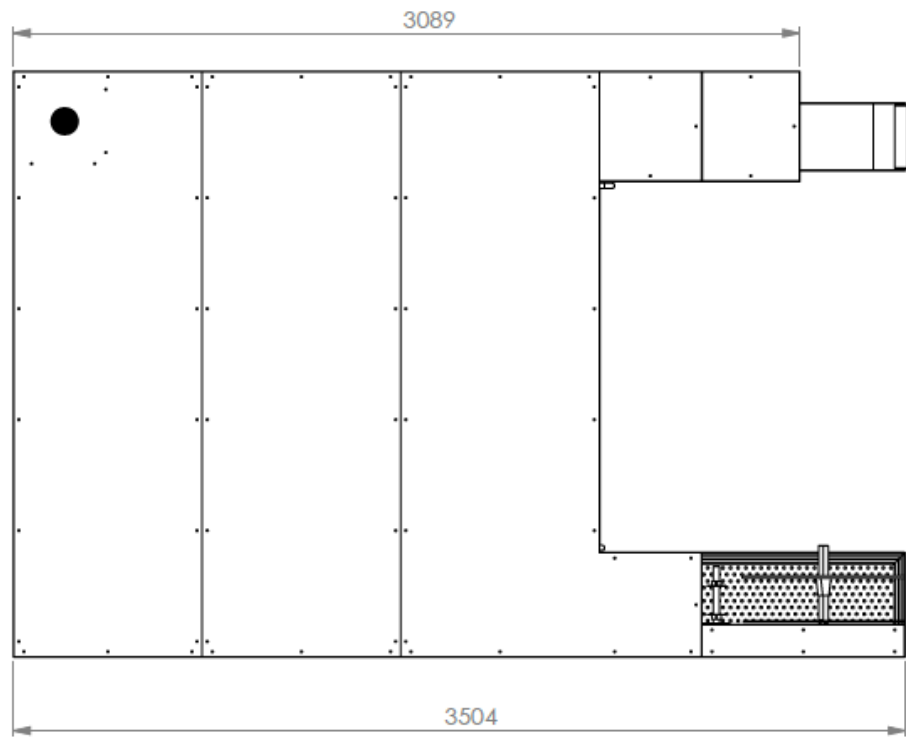
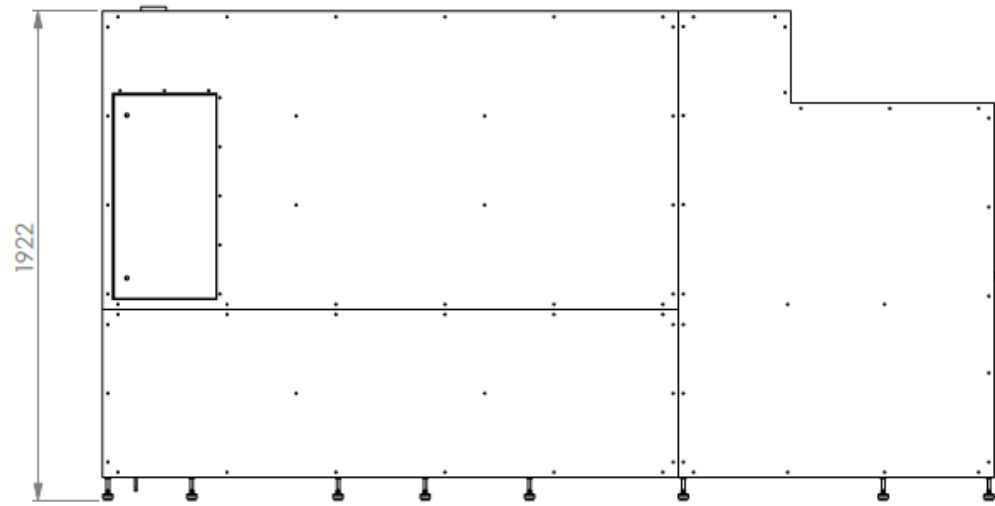

INSPIRATION HOSE MAINTENANCE ROOM

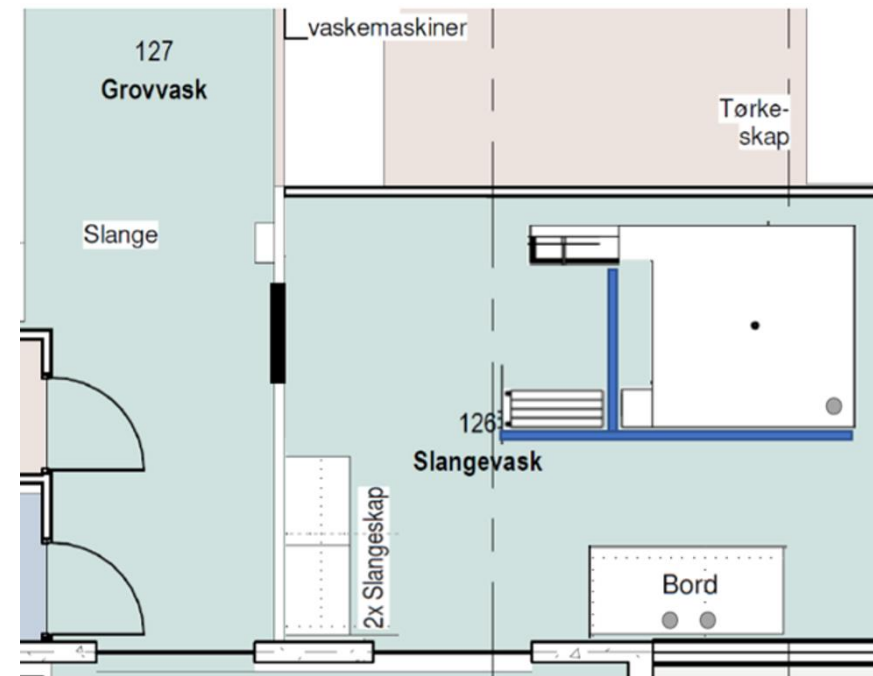
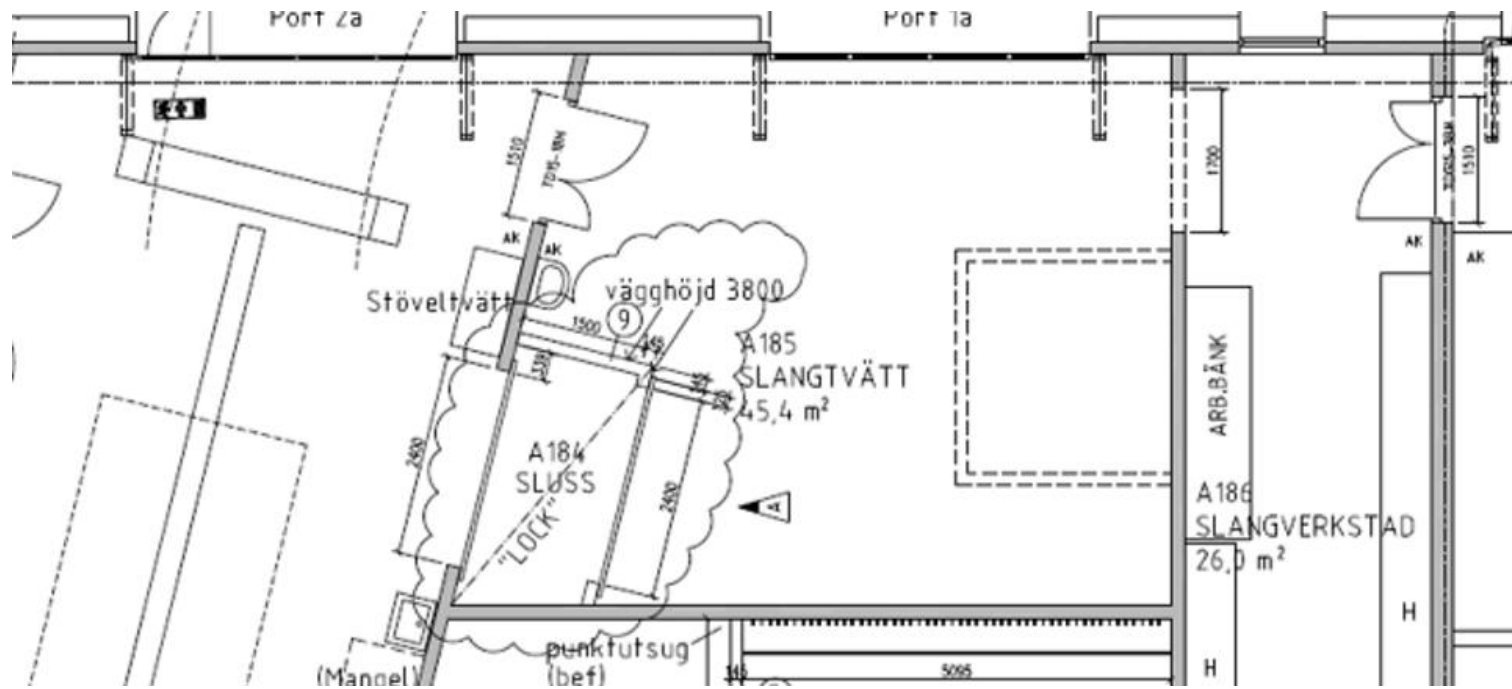

Slangvårdsrum

WERMA CONCEPT PRICES



99 995 euro

HM200, hose maintenance machine

- Washing with both HP-nozzles and brushes as standard
- 1–3-inch standard (4 inch extra feature)
- Pressure test 18 bar the whole hose and couplings in one cycle (25 bar extra feature)
- Drying
- Single- and/or double winds
- Full recycling of pressure testing water
- Internet connection to support and updaters

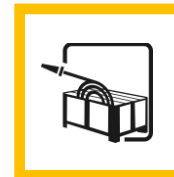

900 euro

Transport boxes

- Small hoses
- Big hoses



650 euro

Hose shelves 1000 mm

- Self drainage
- 3 shelves



6000 euro

Crimping machine CM3000

- Incl two dimensions

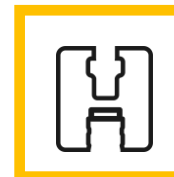

6000 euro

Crimp ring remover CR1800

- Incl two dimensions

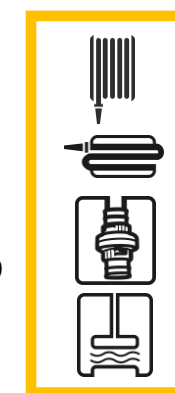

Hose shop

- vulcanizer
- Folding machine
- Hose storage
- Couplings
- Crimping rings

Warranty

Everyday maintenance must be done accordingly

After warranty

2 years

Telephone support during office hours – free of charge

Telephone support during office hours – free of charge

Wear parts that need to be changed
– **according to price list**
Repairs at not normal usage or damage –
according to price list

Warranty repairs
Free of charge

2 free of charge planned service-
trips (travel & living is charged)

Spare parts that need
to be exchanged
Free of charge

Annually planned service trip is recommended

- Base price for service with included updates of software and updated training.
- Possible change of spare parts is on top of the service cost.

Technician on site

- Cost per hour on site
- Cost per hour on travel
- Cost per km
- Cost for hotel and traktamente
- Spare and wear parts – according to price list

Purchase of spare part box is recommended.
To be able to do simpler and fast repairs by
your own. With telephone support.

SERVICE AND SUPPORT ORGANISATION

European network of technicians

Meetings online every 2nd month

For training and support internally

Telephone support and remote

HOSE MAINTENANCE AND HOSE SHOP

Hose maintenance



01

Transport boxes for logistics and handling of both dirty and clean hoses

02

Crimping machine to crimp 19 – 76 mm hoses

03

Draining hose shelves for hose storage, and transport from hose maintenance machine to hose storage.

04

Crimp ring remover. Fast and easy to recycle couplings.



DRYING SYSTEM

Drying system

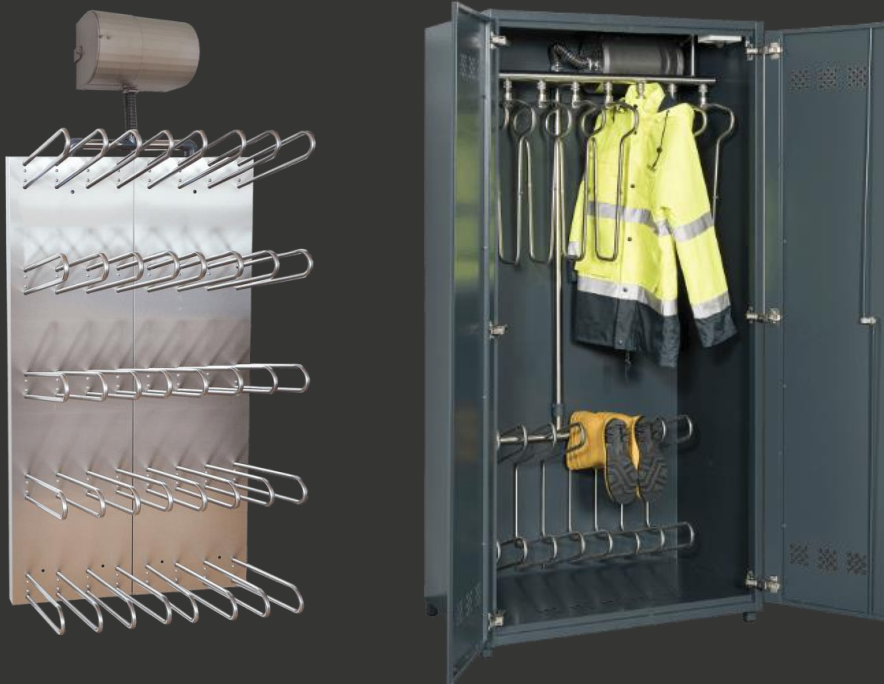

01

High quality and efficient drying systems

02

Can be adapted according to needs and space

03

Drying is done inside -> out and is lower on electrical consumption.

04

Good for the material

CRASH RECOVERY SYSTEM

CRS-bild

Volvo - V60 Plug-in Hybrid - T8 Twin Engine - 5 dörrars kombi - 2018-2020

ID: 93069

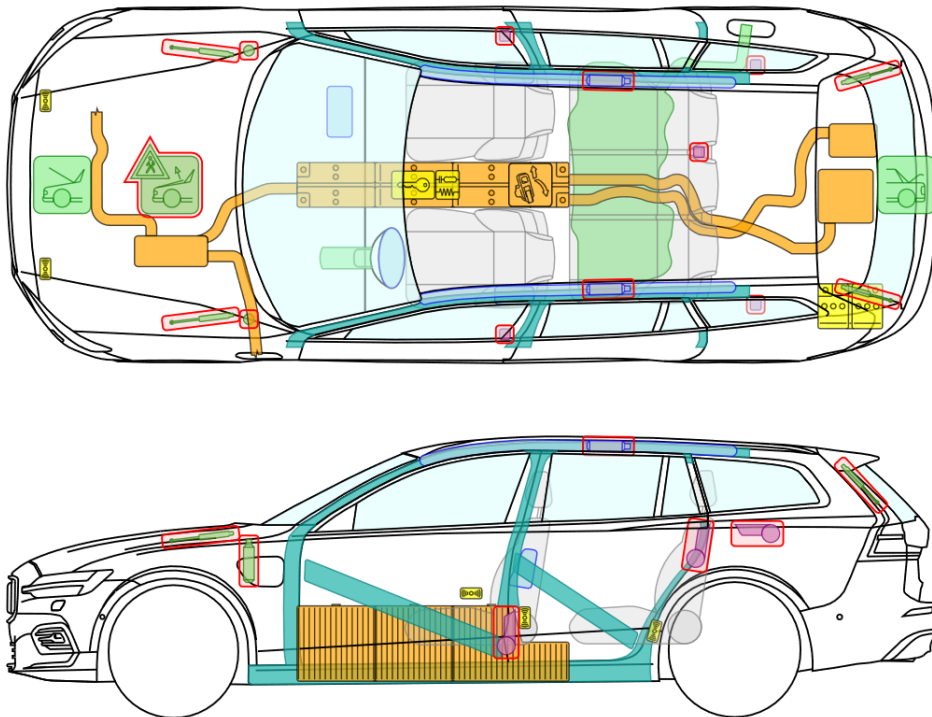

Dölj tak

Dölj sida

Dölj säten

Visa avaktivering

Visa info

Visa teckenförklaring



VO_18_08_00004 | v1.2 | DB: 20-Dec-2019-01

powered by Moditech Rescue Solutions BV

FIRE HOSES

Own series of hoses

Fuji – standard hoses
Everest – premium hoses
Fryken – rubber hoses
Glaciär – snow production

werma - FUJI | BRAND - OCH INDUSTRIERLANG



Certified according to
DIN EN ISO 9001 : 2015
Quality Management System

werma - EVEREST | REFL. BRAND - OCH INDUS



Certified according to
DIN EN ISO 9001 : 2015
Quality Management System

werma - FRYKEN | HEAVY DUTY BRAND - OCH INDUSTRIERLANG



Certified according to
DIN EN ISO 9001 : 2015
Quality Management System



PARSCH
Schläuche • Armaturen

werma

TRAINING FACILITIES & MOCK-UPS

Training for rescue
personnel



01

Our training facilities and mock-ups put focus on the individual development.

02

The facilities are in technical advance and the software that operates them is unique.

03

As well as supplying a new facility we gladly refurbish and upgrade your present training facility or mock-up.

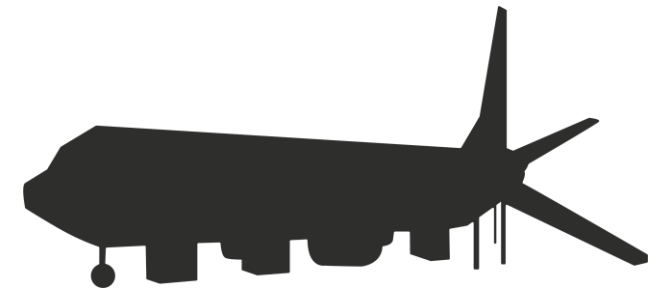



- ① Mobil vagnväska till Fire sniffer
- ② Fire Sniffer
- ③ Munstycke: nyckelhål
- ④ Munstycke: stängd dörrar
- ⑤ Munstycke: brevinkast
- ⑥ Luftflödesindikator

FIRE SNIFFER - MOBIL KÖRDETEKTÖR

Fire Sniffer (Cirrus Pro Locator)

En mobilt hjälpmedel för att identifiera misstänkt brand eller rökutveckling i svåråtkomliga områden och bakom stängda dörrar. Fire Sniffer kan hanteras från vagnväskan eller handhållen. Den är utrustad med olika provtagningshuvuden för brevinkast, nyckelhål och stängda dörrar. Fire Sniffer laddas direkt i brandbilen.

Teknisk data:

Effekt:	24 VDC (två 12 V 1.3 Ah SLA batterier)
Laddare:	12 VDC - 24 VDC
Säkring:	T2 A 32 mm x 6 mm
Batteritid:	2 timme
Arbetstemperatur:	0 - 54°C
Fuktighet:	0 - 95% RH, icke kondenserande
Platsindikator:	LED level indikator
Andra indikatorer:	Batteritid, felmeddelande, LCD monitor

	Firesniffer exkl. vagnväska	Firesniffer inkl vagnväska
Höjd (mm)	255 (340 inkl. bärhandtag)	419
Bredd (mm)	319	473
Djup (mm)	118	235
Vikt (kg)	5	10,8

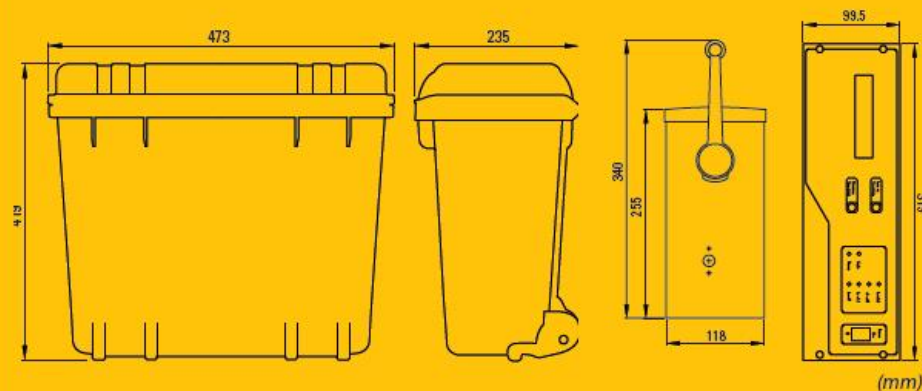

A photograph of two firefighters, a woman on the left and a man on the right, standing in a fire station. They are both wearing helmets and smiling at the camera. The woman is wearing a white helmet and a dark shirt, while the man is wearing a yellow helmet and a tan jacket. A red fire truck is visible in the background. The Werma logo is overlaid in the center.

werma

www.werma.se